

EVSE Retractor Installation Instructions

ATG Electronics, Inc.

10588 Monte Vista Ave, Montclair, CA 91763
 +1-951-245-6222 service@atgelectronics.com https://www.atgelectronics.com/

EVSE Retractor Accessories List

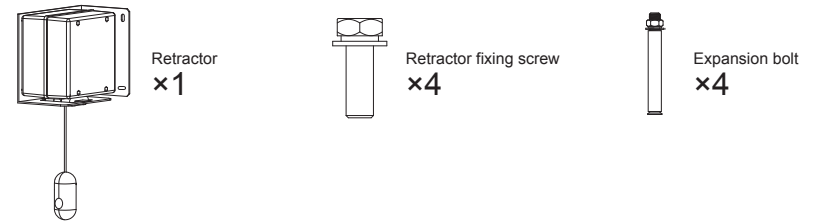

EVSE Retractor Data and Specifications

Dimension	9.6in × 6.5in × 2.52in (244mm × 164mm × 64mm)
Weight	7.2LBs/3.3kg
Cable Winding Length	13FT (4m)
Pulling and Rolling Strength	≥2.2LBs
Operating Temperature	-22°F to 122°F (-30°C to 50°C)
Life Span	≥ 10000 times (Slow pull natural recovery)
Output Cable	Connects to existing EVSE. Type 1 SAE J1772 cord, AC Level 2, 32-48A rated (7.6-11.5 kW) Cable Management System is only available in 7FT pedestal.

Step 1

Remove the retractor from the package

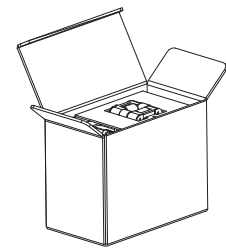

Figure 1

Step 2

Pull out the cable at about 11.8in, then stop, and the retractor will self-lock at the position (Reference Figure 2)

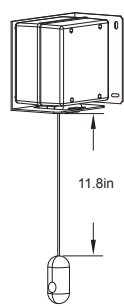

Figure 2

Step 3

Unassemble the retractor body from the mounting plate (Reference Figure 3). Remove the screws on the cord clamp, then remove the 4 screws from the mounting plate to separate the retractor body from the mounting plate.

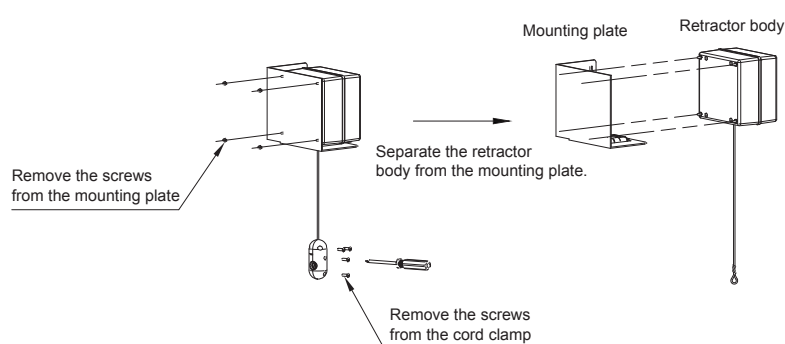
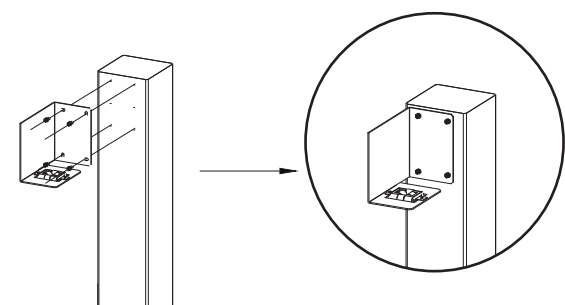

Figure 3

Step 4

4.1 Reference Figure 4, use 4 screws to secure the mounting plate on the pedestal.



Install the mounting plate on the pedestal

Figure 4

4.2 Reference Figure 5, use 4 screws to secure the mounting plate on the wall.

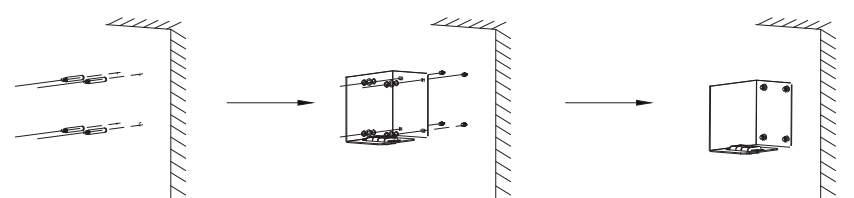

Drill 4 holes on the wall accordance to the mounting plate screw position, then install the expansion bolt. (Size: diameter φ10mm, depth 45mm)

Figure 5

Step 5

Reference Figure 6, position the retractor body to the mounting plate and secure the retractor body with the 4 screws to the mounting plate.

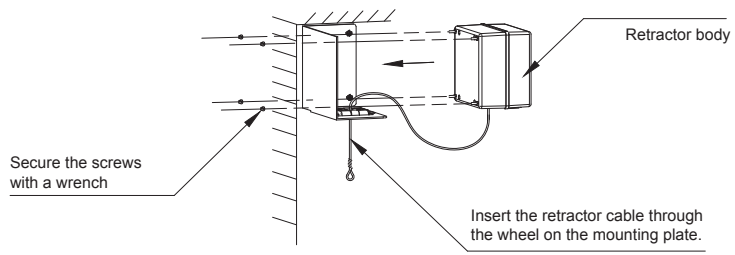
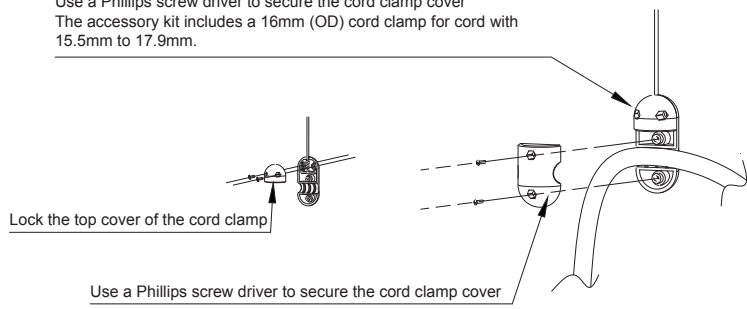

Figure 6

Step 6

Reference Figure 7. Install the cord clamp and use the cord clamp to clamp the EV charger output cable

The product comes with 20mm (OD) cord clamp for cord with 22mm - 22.7mm diameter.
Lock the top cover of the cord clamp
Use a Phillips screw driver to secure the cord clamp cover
The accessory kit includes a 16mm (OD) cord clamp for cord with 15.5mm to 17.9mm.



Install the cord clamp (Ensure the cord clamp has at least 1.2 meter distance from the charging gun)

Figure 7

The Effect Picture after Installation

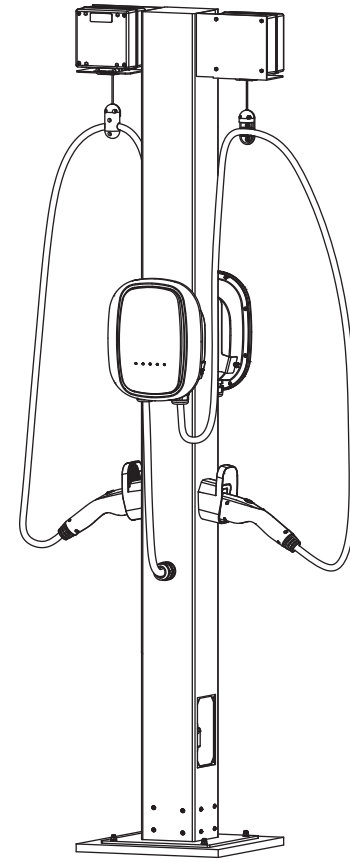

7FT Pedestal